

# Product leaflet

**Product**  
Test adapter

**Model No.**  
SR 328

**Ordering No.**  
T01-1202

## Product Description

The SR 328 test adapter is used for connecting the SR 90-3 / SR 100 / SR 900 half mask Air Purifying Respirator (APR) to a measuring instrument for carrying out quantitative fit test. The adapter is connected to one of the exhalation valves of the mask.

The adapter is intended for use only for quantitative fit testing under test conditions. It must not be used under real work conditions.

- A. Valve seat of the mask**
- B. Adapter**
- C. Tube**
- D. Exhalation valve membrane**
- E. Valve cover**

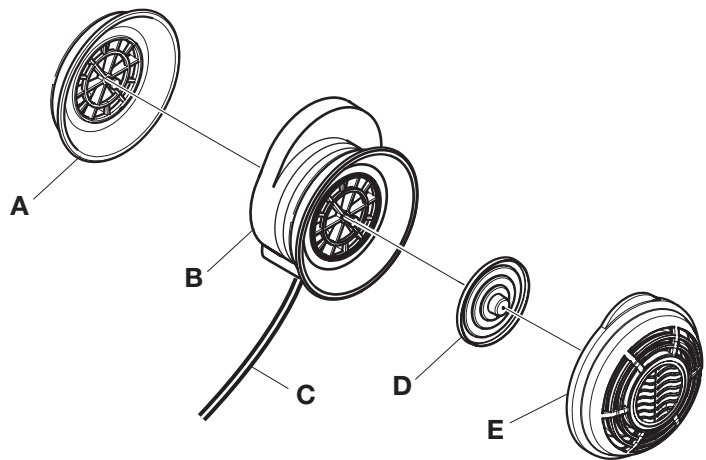

**Sundstrom Safety Inc.**

143 Maple St.  
Warwick, RI 02888

Office: 1-401-434-7300  
Toll Free: 1-877-SUNDSTROM  
Fax: 1-401-434-8300

info@srsafety.com  
www.srsafety.com